

040397

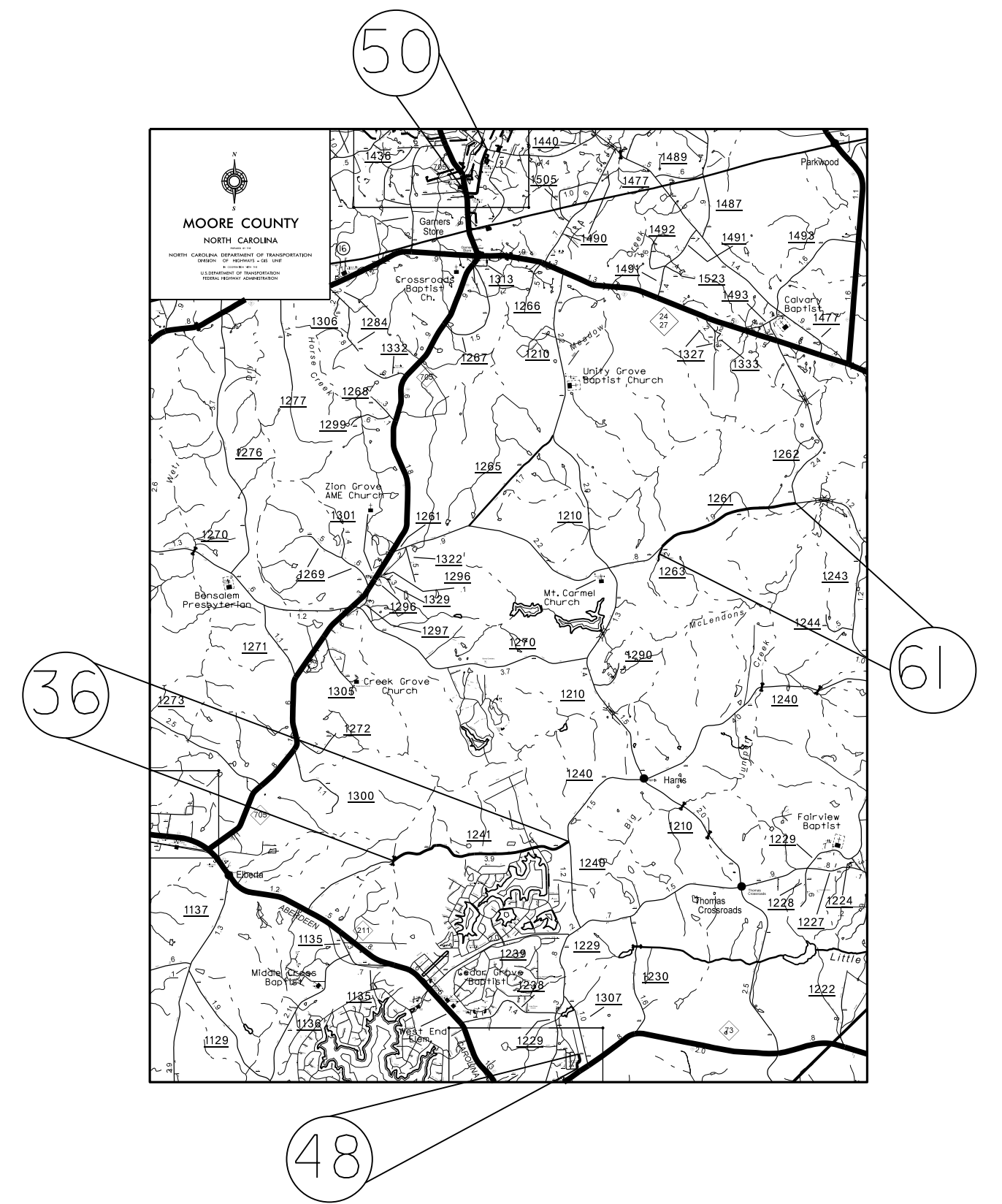

US TIME SENSITIVE INFORMATION

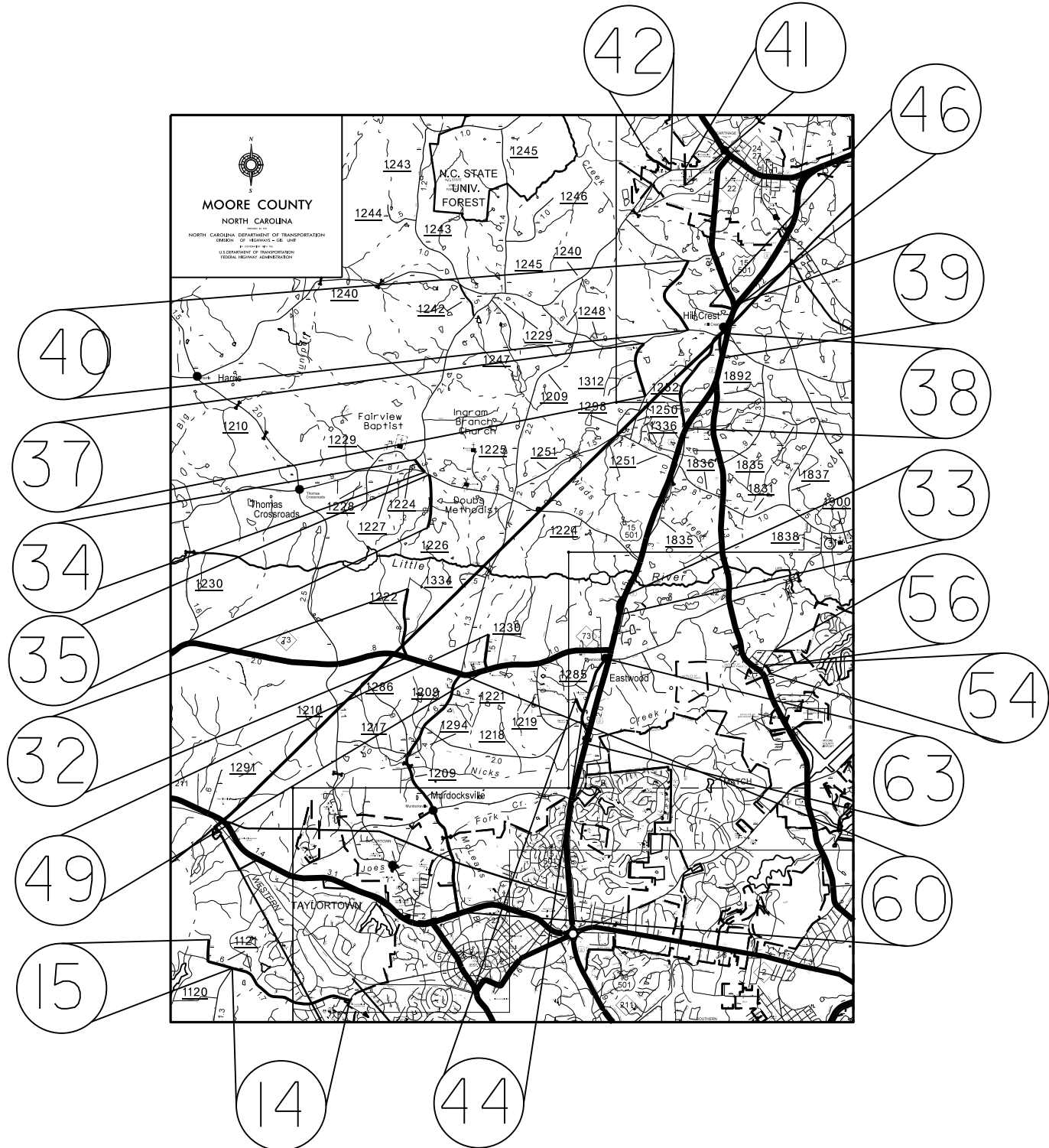
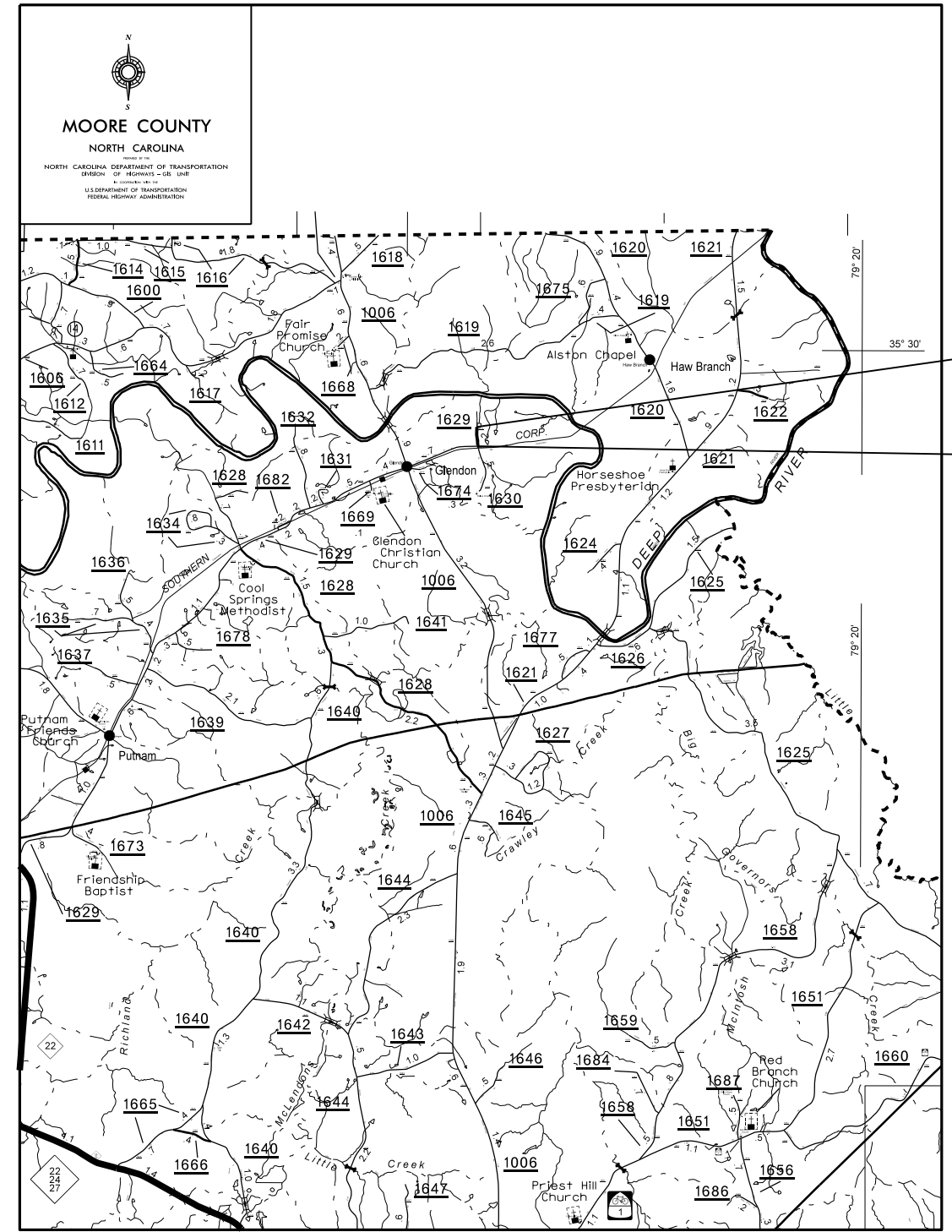
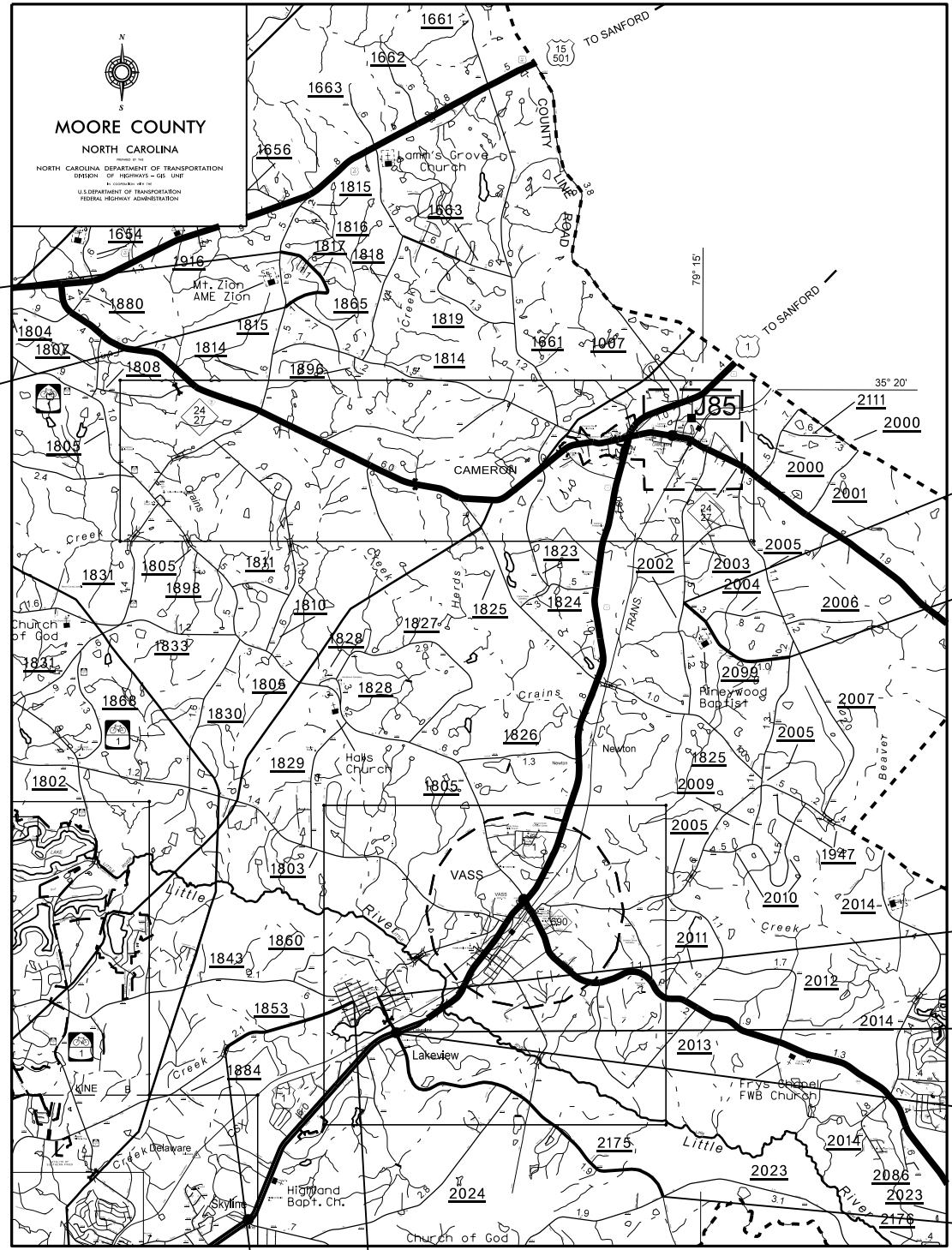

040397  
 SYSTEMS DESIGN  
 2017CPT.08.17.20632

PROJECT NO.	SHEET NO.	TOTAL NO.
2017CPT.08.17.20632	6	

## SUMMARY OF QUANTITIES

PROJECT NO.	COUNTY	MAP NO.	ROUTE	DESCRIPTION	LANES	LANE TYPE	LENGTH MI	WIDTH FT	ASPHALT SURFACE TREATMENT, SLURRY SEAL SY	ASPHALT SURFACE TREATMENT, DOUBLE SEAL SY	ASPHALT SURFACE TREATMENT, TRIPLE SEAL SY	EMULSION FOR ASPHALT SURFACE TREATMENT GAL	BLOTTING SAND TON
2017CPT.08.17.20632	Moore	1	SR 1105 (PINEBLUFF LAKE RD)	FROM US 15 TO SR 1104 (PINEBLUFF CEMETARY RD)	2	2WU	2.106	22		27,178.00		14,948	
<b>TOTAL FOR MAP NO. 1</b>													
2017CPT.08.17.20632	Moore	2	SR 1176 (COUNTRYSIDE DR)	FROM SR 1105 (PINEBLUFF LAKE RD) TO END MAINT	2	2WU	0.5	20		5,867.00		3,227	
<b>TOTAL FOR MAP NO. 2</b>													
2017CPT.08.17.20632	Moore	3	SR 1204 (MURRAY HILL RD)	FROM US 15 TO DEAD END	2	2WU	0.3	20		3,520.00		1,936	
<b>TOTAL FOR MAP NO. 3</b>													
2017CPT.08.17.20632	Moore	4	SR 1311 (MAGNOLIA DR)	FROM END OF C&G TO END MAINT	2	2WU	0.503	18	5,308.00				
<b>TOTAL FOR MAP NO. 4</b>													
2017CPT.08.17.20632	Moore	5	SR 1853 (CAMP EASTER RD)	FROM US 1 TO SR 1861 (HOLLY RD)	2	2WU	0.395	20	4,634.00				
<b>TOTAL FOR MAP NO. 5</b>													
2017CPT.08.17.20632	Moore	6	SR 2030 (NORTH RIDGE ST)	FROM SR 2174 (SHIELDS RD) TO DEAD END	2	2WU	0.41	18		4,330.00		2,382	
<b>TOTAL FOR MAP NO. 6</b>													
2017CPT.08.17.20632	Moore	7	SR 2063 (PEEDEE RD)	FROM NC 211 TO US 15	2	2WU	1.413	24		21,509.00		11,830	
<b>TOTAL FOR MAP NO. 7</b>													
2017CPT.08.17.20632	Moore	8	SR 2078 (HIGHT RD)	FROM US 15-501 TO END MAINT	2	2WU	0.36	18		3,802.00		2,092	
<b>TOTAL FOR MAP NO. 8</b>													
2017CPT.08.17.20632	Moore	9	SR 2175 (AIKEN ROAD)	FROM SR 2023 ( LAKEBAY RD) TO US 1	2	2WU	3.61	20		42,358.00		23,297	
<b>TOTAL FOR MAP NO. 9</b>													
2017CPT.08.17.20632	Moore	10	SR 2182 (CHAPEL GREENS PL)	FROM SR 2063 (PEEDEE RD) TO END MAINT	2	2WU	0.11	20		1,291.00		710	
<b>TOTAL FOR MAP NO. 10</b>													
2017CPT.08.17.20632	Moore	11	SR 1101 (HAMMOND RD)	FROM SR 1100 (ADDOR RD) TO END OF MAINT	2	2WU	0.58	18		6,125.00		3,369	
<b>TOTAL FOR MAP NO. 11</b>													
2017CPT.08.17.20632	Moore	12	SR 1106 (BATCHELOR FARM RD)	FROM US 1 TO SR 1112 (ROSELAND RD)	2	2WU	0.58	18		6,125.00		3,369	
<b>TOTAL FOR MAP NO. 12</b>													
2017CPT.08.17.20632	Moore	13	SR 1111 (PARK DR)	FROM SR 1112 (ROSELAND RD) TO SCL ABERDEEN	2	2WU	0.19	18	2,007.00				
<b>TOTAL FOR MAP NO. 13</b>													
2017CPT.08.17.20632	Moore	14	SR 1121 (CHICKEN PLANT RD)	FROM SR 1115 (LINDEN RD) TO SR 1120 (BOWMAN RD)	2	2WU	1.669	20		19,585.00		10,772	
<b>TOTAL FOR MAP NO. 14</b>													
2017CPT.08.17.20632	Moore	15	SR 1121 (CHICKEN PLANT RD)	FROM SR 1120 (BOWMAN RD) TO DEAD END	2	2WU	0.595	20		6,978.00		3,838	
<b>TOTAL FOR MAP NO. 15</b>													
2017CPT.08.17.20632	Moore	16	SR 1124 (DERBY RD)	FROM MONTGOMERY COUNTY LINE TO NC 73	2	2WU	2.23	18		23,549.00		12,952	
<b>TOTAL FOR MAP NO. 16</b>													
2017CPT.08.17.20632	Moore	17	SR 1129 (CURRIE MILL RD)	FROM SR 1137 (FLOWERS RD) TO SR 1136( LUCAS ROAD)	2	2WU	1.88	20		22,059.00		12,133	
<b>TOTAL FOR MAP NO. 17</b>													
2017CPT.08.17.20632	Moore	18	SR 1130 (CANDY RD)	FROM SR 1129 (CURRIE MILL RD) TO DEAD END	2	2WU	0.5	18	5,280.00				
<b>TOTAL FOR MAP NO. 18</b>													
2017CPT.08.17.20632	Moore	19	SR 1136 (LUCAS RD)	FROM SR 1135 (DEAD MAN CURVE RD) TO RR	2	2WU	0.126	20			1,483.00	816	
<b>TOTAL FOR MAP NO. 19</b>													
2017CPT.08.17.20632	Moore	20	SR 1136 (LUCAS RD)	FROM RR TO SR 1129 ( CURRIE MILL RD)	2	2WU	2.005	20			23,525.00	12,939	
<b>TOTAL FOR MAP NO. 20</b>													
2017CPT.08.17.20632	Moore	21	SR 1138 (EAGLE SPRINGS RD)	FROM SR 1138 (EAGLE SPRINGS RD) TO SR 1140 (MARTIN RD)	2	2WU	1.235	18		13,044.00		7,175	
<b>TOTAL FOR MAP NO. 21</b>													
2017CPT.08.17.20632	Moore	22	SR 1140 (MARTIN RD)	FROM SR 1126 (MILL RD) TO SR 1141 (ROBERT RD)	2	2WU	1.24	18		13,095.00		7,202	
<b>TOTAL FOR MAP NO. 22</b>													
2017CPT.08.17.20632	Moore	23	SR 1140 (MARTIN RD)	FROM SR 1141 (ROBERT RD) TO SR 1139 (EAGLE BRANCH RD)	2	2WU	2	18		21,120.00		11,616	
<b>TOTAL FOR MAP NO. 23</b>													
2017CPT.08.17.20632	Moore	24	SR 1143 (SAMARCAND RD)	FROM SR 1275 (BIG OAK CHURCH RD) TO NC 211	2	2WU	3.53	18		37,277.00		20,503	
<b>TOTAL FOR MAP NO. 24</b>													
2017CPT.08.17.20632	Moore	25	SR 1144 (WEST SAMARCAND RD)	FROM MONTGOMERY COUNTY LINE) TO SR 1143 (SAMARCAND RD)	2	2WU	0.51	18		5,386.00		2,963	
<b>TOTAL FOR MAP NO. 25</b>													
2017CPT.08.17.20632	Moore	26	SR 1145 (CANDOR RD)	FROM MONTGOMERY COUNTY LINE TO SR 1143 (SAMARCAND RD)	2	2WU	1.4	18		14,784.00		8,132	
<b>TOTAL FOR MAP NO. 26</b>													
2017CPT.08.17.20632	Moore	27	SR 1149 (SEYMOUR ST)	FROM SR 1112 (ROSELAND RD) TO SCL ABERDEEN	2	2WU	0.06	20		704.00		388	
<b>TOTAL FOR MAP NO. 27</b>													
2017CPT.08.17.20632	Moore	28	SR 1151 (COMMUNITY CENTER RD)	FROM SR 1117 (COTTON ST) TO SR 1118 (GAINES ST)	2	2WU	0.09	20		1,056.00		581	
<b>TOTAL FOR MAP NO. 28</b>													
2017CPT.08.17.20632	Moore	29	SR 1152 (HEFLIN RD)	FROM US 15-501 TO US 15-501	2	2WU	0.57	20		6,688.00		3,679	
<b>TOTAL FOR MAP NO. 29</b>													
2017CPT.08.17.20632	Moore	30	SR 1168 (MYRTLE RD)	FROM SR 1126 (MILL RD) TO DEAD END	2	2WU	0.21	20			2,464.00	1,356	
<b>TOTAL FOR MAP NO. 30</b>													
2017CPT.08.17.20632	Moore	31	SR 1174 (WESTVIEW LP)	FROM SR 1173 (N. BERRY ST) TO SR 1173 (N. BERRY ST)	2	2WU	0.49	20		5,750.00		3,163	
<b>TOTAL FOR MAP NO. 31</b>													

PROJECT NO.	SHEET NO.	TOTAL NO.
2017CPT.08.17.20632	6A	

## SUMMARY OF QUANTITIES

PROJECT NO	COUNTY	MAP NO	ROUTE	DESCRIPTION	LANES	LANE TYPE	LENGTH	WIDTH	ASPHALT SURFACE TREATMENT, SLURRY SEAL	ASPHALT SURFACE TREATMENT, DOUBLE SEAL	ASPHALT SURFACE TREATMENT, TRIPLE SEAL	EMULSION FOR ASPHALT SURFACE TREATMENT	BLOTTING SAND
2017CPT.08.17.20632	Moore	32	SR 1222 (RUBICON RD)	FROM NC 73 TO DEAD END	2	2WU	0.89	18		9,399.00		5,170	
<b>TOTAL FOR MAP NO. 32</b>													
2017CPT.08.17.20632	Moore	33	SR 1223 (BOGGS RD)	FROM US 15-501 TO DEAD END	2	2WU	0.25	18		2,640.00		1,452	
<b>TOTAL FOR MAP NO. 33</b>													
2017CPT.08.17.20632	Moore	34	SR 1224 (DOUBS CHAPEL RD)	FROM SR 1229 (CARTHAGE RD TO SR 1227 (KANOY RD)	2	2WU	0.21	22		2,711.00		1,491	
<b>TOTAL FOR MAP NO. 34</b>													
2017CPT.08.17.20632	Moore	35	SR 1226 (CARLTON C RD)	FROM SR 1224 (DOUBS CHAPEL RD) TO PAVEMENT CHANGE	2	2WU	0.67	20		7,862.00		4,325	
<b>TOTAL FOR MAP NO. 35</b>													
2017CPT.08.17.20632	Moore	36	SR 1241 (HOLLY GROVE SCHOOL RD)	FROM SR 1240 (DOWD RD) TO PIPE P-109	2	2WU	2.5	20		29,334.00		16,134	
<b>TOTAL FOR MAP NO. 36</b>													
2017CPT.08.17.20632	Moore	37	SR 1249 (COOK RD)	FROM SR 1248 (SUMMER HILL CH RD) TO SR 1250 (JODY ROAD)	2	2WU	0.714	20		8,374.00		4,606	
<b>TOTAL FOR MAP NO. 37</b>													
2017CPT.08.17.20632	Moore	38	SR 1252 (SHADY LANE RD)	FROM SR 1254 (LEGION HUT RD) TO US 15-501	2	2WU	1.41	18		14,890.00		8,190	
<b>TOTAL FOR MAP NO. 38</b>													
2017CPT.08.17.20632	Moore	39	SR 1254 (LEGION HUT RD)	FROM US 15-501 TO NC 22	2	2WU	0.71	18		7,498.00		4,124	
<b>TOTAL FOR MAP NO. 39</b>													
2017CPT.08.17.20632	Moore	40	SR 1255 (HARDY RD)	FROM SR 1256 (CONNELL RD) TO SR 1248 (SUMMER HILL CHURCH ROAD)	2	2WU	1.061	18		11,204.00		6,163	
<b>TOTAL FOR MAP NO. 40</b>													
2017CPT.08.17.20632	Moore	41	SR 1258 (PINCKNEY RD)	FROM SR 1240 (DOWD RD) TO DEAD END	2	2WU	0.2	18		2,112.00		1,162	
<b>TOTAL FOR MAP NO. 41</b>													
2017CPT.08.17.20632	Moore	42	SR 1259 (JEFFERS RD)	FROM SR 1240 (DOWD RD) TO DEAD END	2	2WU	0.39	18		4,119.00		2,266	
<b>TOTAL FOR MAP NO. 42</b>													
2017CPT.08.17.20632	Moore	43	SR 1280 (OLD BARN RD)	FROM NC 211 TO MONTGOMERY COUNTY LINE	2	2WU	1.08	20		12,672.00		6,970	
<b>TOTAL FOR MAP NO. 43</b>													
2017CPT.08.17.20632	Moore	44	SR 1303 (JACKSON RD)	FROM SR 1285 (LEA RD) TO DEAD END	2	2WU	0.2	20		2,347.00		1,291	
<b>TOTAL FOR MAP NO. 44</b>													
2017CPT.08.17.20632	Moore	45	SR 1304 (POSSUM HOLLER RD)	FROM SR 1274 (SAW GRASS RD) TO DEAD END	2	2WU	0.59	18		6,230.00		3,427	
<b>TOTAL FOR MAP NO. 45</b>													
2017CPT.08.17.20632	Moore	46	SR 1316 (FRYE RD)	FROM SR 1254 (LEGION HUT RD) TO DEAD END	2	2WU	0.3	18		3,168.00		1,743	
<b>TOTAL FOR MAP NO. 46</b>													
2017CPT.08.17.20632	Moore	47	SR 1318 (ARNOLD AVE)	FROM WCL OF ABERDEEN TO DEAD END	2	2WU	0.2	18		2,112.00		1,162	
<b>TOTAL FOR MAP NO. 47</b>													
2017CPT.08.17.20632	Moore	48	SR 1320 (HAPPY VALLEY RD)	FROM SR 1231 (PATTON RD) TO DEAD END	2	2WU	0.21	20		2,464.00		1,356	
<b>TOTAL FOR MAP NO. 48</b>													
2017CPT.08.17.20632	Moore	49	SR 1330 (BERTIE RD)	FROM NC 73 TO DEAD END	2	2WU	0.46	20		5,398.00		2,969	
<b>TOTAL FOR MAP NO. 49</b>													
2017CPT.08.17.20632	Moore	50	SR 1441 (GARDENIA RD)	FROM SR 1440 (HEMP ST EXT) TO NC 705	2	2WU	0.734	20		8,612.00		4,737	
<b>TOTAL FOR MAP NO. 50</b>													
2017CPT.08.17.20632	Moore	51	SR 1629 (PUTNAM-GLENDON RD)	FROM SR 1630 ( DICKERSON RD) TO DEAD END	2	2WU	0.206	20		2,414.00		1,328	
<b>TOTAL FOR MAP NO. 51</b>													
2017CPT.08.17.20632	Moore	52	SR 1817 ( T. JOHNSON RD)	FROM SR 1815 (BRYANT RD) TO SR 1815 (BRYANT RD)	2	2WU	1.16	20		13,611.00		7,487	
<b>TOTAL FOR MAP NO. 52</b>													
2017CPT.08.17.20632	Moore	53	SR 1853 (CAMP EASTER RD)	FROM BRIDGE NO 183 TO SR 1843 (SAMANTHA LN)	2	2WU	1.359	20		15,943.00		8,769	
<b>TOTAL FOR MAP NO. 53</b>													
2017CPT.08.17.20632	Moore	54	SR 1907 (WEDGEWOOD CIR)	FROM SR 1841 (RAYS BRIDGE RD) TO SR 1840 (MICHAEL RD)	2	2WU	0.14	20		1,643.00		904	
<b>TOTAL FOR MAP NO. 54</b>													
2017CPT.08.17.20632	Moore	55	SR 1914 (LONG PINE HILLS RD)	FROM SR 1931 (OLD MORGANTON RD) TO DEAD END	2	2WU	0.1	18		1,056.00		580	
<b>TOTAL FOR MAP NO. 55</b>													
2017CPT.08.17.20632	Moore	56	SR 1915 (FOXCROFT RD)	FROM SR 1840 (MICHAEL RD) TO SR 1841 (RAYS BRIDGE RD)	2	2WU	0.37	20		4,342.00		2,389	
<b>TOTAL FOR MAP NO. 56</b>													
2017CPT.08.17.20632	Moore	57	SR 2099 (PINEYWOOD CH RD)	FROM SR 2005 (ATKINS RD) TO SR 2004 (LANE RD)	2	2WU	1.04	20		12,203.00		6,712	
<b>TOTAL FOR MAP NO. 57</b>													
2017CPT.08.17.20632	Moore	58	SR 2029 (YADKIN RD)	FROM SR 2080 (MAY ST) TO DEAD END	2	2WU	0.36	20	4,224.00				
<b>TOTAL FOR MAP NO. 58</b>													
2017CPT.08.17.20632	Moore	59	SR 2031 (DUNCAN RD)	FROM SR 2080 (MAY ST) TO SR 2133 (SHELDON ST)	2	2WU	0.26	20		3,052.00		1,679	
<b>TOTAL FOR MAP NO. 59</b>													
2017CPT.08.17.20632	Moore	60	SR 1209 (MURDOCKSVILLE RD)	FROM NC 211 TO NC 73	2	2WU	3.43	20		40,246.00		22,136	
<b>TOTAL FOR MAP NO. 60</b>													
2017CPT.08.17.20632	Moore	61	SR 1261 (BETHLEHEM CH RD)	FROM SR 1263 (SCOTCH BURYING RD) TO SR 1262 (LEATHERWOOD RD)	2	2WU	1.9	20		22,294.00		12,262	
<b>TOTAL FOR MAP NO. 61</b>													
2017CPT.08.17.20632	Moore	62	SR 1276 (GURNEY RD)	FROM NC 24 TO SR 1434 (TALC MINE RD)	2	2WU	2.35	20		27,574.00		15,166	
<b>TOTAL FOR MAP NO. 62</b>													
2017CPT.08.17.20632	Moore	63	SR 1285 (LEA ROAD)	FROM US 15-501 TO US 15-501	2	2WU	1.25	20		14,667.00		8,067	
<b>TOTAL FOR MAP NO. 63</b>													
<b>TOTAL FOR PROJ NO. 2017CPT.08.17.20632</b>							<b>58.101</b>		<b>21,453.00</b>	<b>611,569.00</b>	<b>27,472.00</b>	<b>353,585</b>	<b>50</b>
<b>GRAND TOTAL</b>							<b>58.101</b>		<b>21,453.00</b>	<b>615,371.00</b>	<b>27,472.00</b>	<b>353,585</b>	<b>50</b>







## SIGNING FOR ASPHALT SURFACE TREATMENT

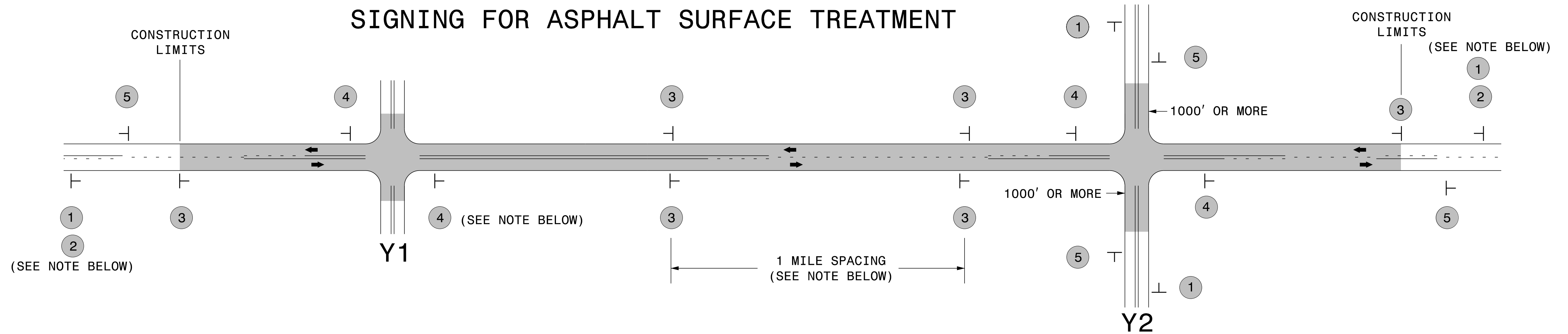

LEGEND	
	STATIONARY SIGN
←	DIRECTION OF TRAFFIC FLOW

### MAINLINE (-L-) SIGNING

### -Y- LINE SIGNING

SIGNING NOTES AND PLACEMENT PER DIRECTION		
1 2	 W20-1 48" X 48" W7-3aP 24" X 18"	<p>PLACE 1000' PRIOR TO BEGINNING OF CONSTRUCTION LIMITS. ONLY USED ON -Y- LINES IF RESURFACING LIMITS EXTEND 1000' ALONG -Y- LINE.</p> <p>#2 SIGN ONLY USED WHEN RESURFACING LIMITS ARE 2 OR MORE MILES IN LENGTH. ROUND UP TO NEXT WHOLE NUMBER. (NO FRACTIONAL OR DECIMAL NUMBERS)</p>
3	 W8-7 48" X 48" SP 48" X 48"	<p>ALTERNATE THE FOLLOWING TWO SIGNS: STARTING WITH "LOOSE GRAVEL" (W8-7) FOLLOWED BY "UNMARKED PAVEMENT".</p> <p>PLACE INITIALLY AT THE CONSTRUCTION LIMITS AND SPACED 1 MILE APART THEREAFTER. IF NO -Y- LINES EXIST, PLACE 2ND SET 1/2 MILE FROM THE CONSTRUCTION LIMITS AND THEN SPACE 1 MILE THEREAFTER.</p>
4	 SP 13106 48" X 48"	<p>THESE ARE FOR -Y- LINES THAT ARE "THROUGH" ROADWAYS. DEAD END AND SUBDIVISION ROADS ARE NOT "THROUGH" ROADWAYS. INSTALL 500' +/- FROM EACH -Y- LINE APPROACH AS SHOWN ABOVE. FOR MULTIPLE -Y- LINES THAT ARE SEPARATED BY 0.25 MILES OR LESS, TREAT AS A SINGLE UNIT AND INSTALL WITHIN 500' OF EACH APPROACH. A MAXIMUM OF 2 SIGN SETS PER MILE. DO NOT INSTALL WHEN -Y- LINES ARE WITHIN 0.5 MILES FROM "END ROAD WORK" SIGN.</p>
5	 G20-2 A 48" X 24"	<p>PLACE 500' FOLLOWING THE END OF CONSTRUCTION LIMITS.</p>

NO REQUIRED STATIONARY SIGNING FOR THE FOLLOWING -Y- LINE CONDITIONS:

- 1) LESS THAN 1000' OF RESURFACING ALONG -Y- LINE
- 2) SUBDIVISION ROADS
- 3) DEAD END ROADS

WHEN PAVING/CONSTRUCTION ACTIVITIES PROCEED ACROSS AN UNSIGNED -Y- LINE, ADVANCE WARNING PORTABLE SIGNS SHALL BE USED ALONG THE -Y- LINE AS SHOWN BELOW. REMOVE UPON COMPLETION OF WORK.



PLACED 500' IN ADVANCE OF FLAGGER. PLACED 250' IN ADVANCE OF FLAGGER.

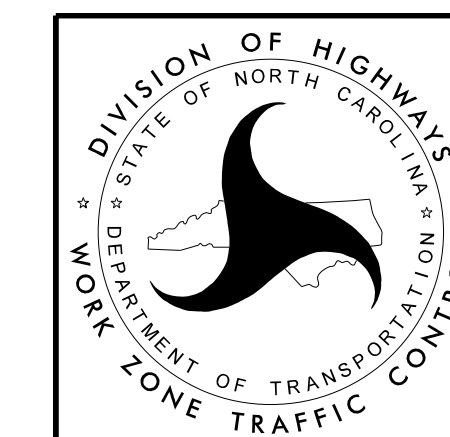

**ADVANCE WARNING SIGNS  
FOR  
ASPHALT SURFACE TREATMENTS  
2 LANE ROADWAYS**